

FIXING CLAMP DETAIL
OPTION 2

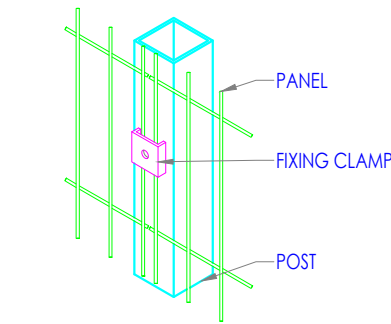

ISOMETRIC VIEW
OPTION 1

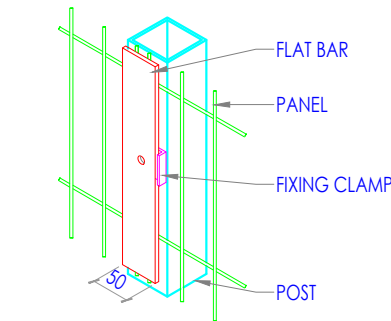

ISOMETRIC VIEW
OPTION 2

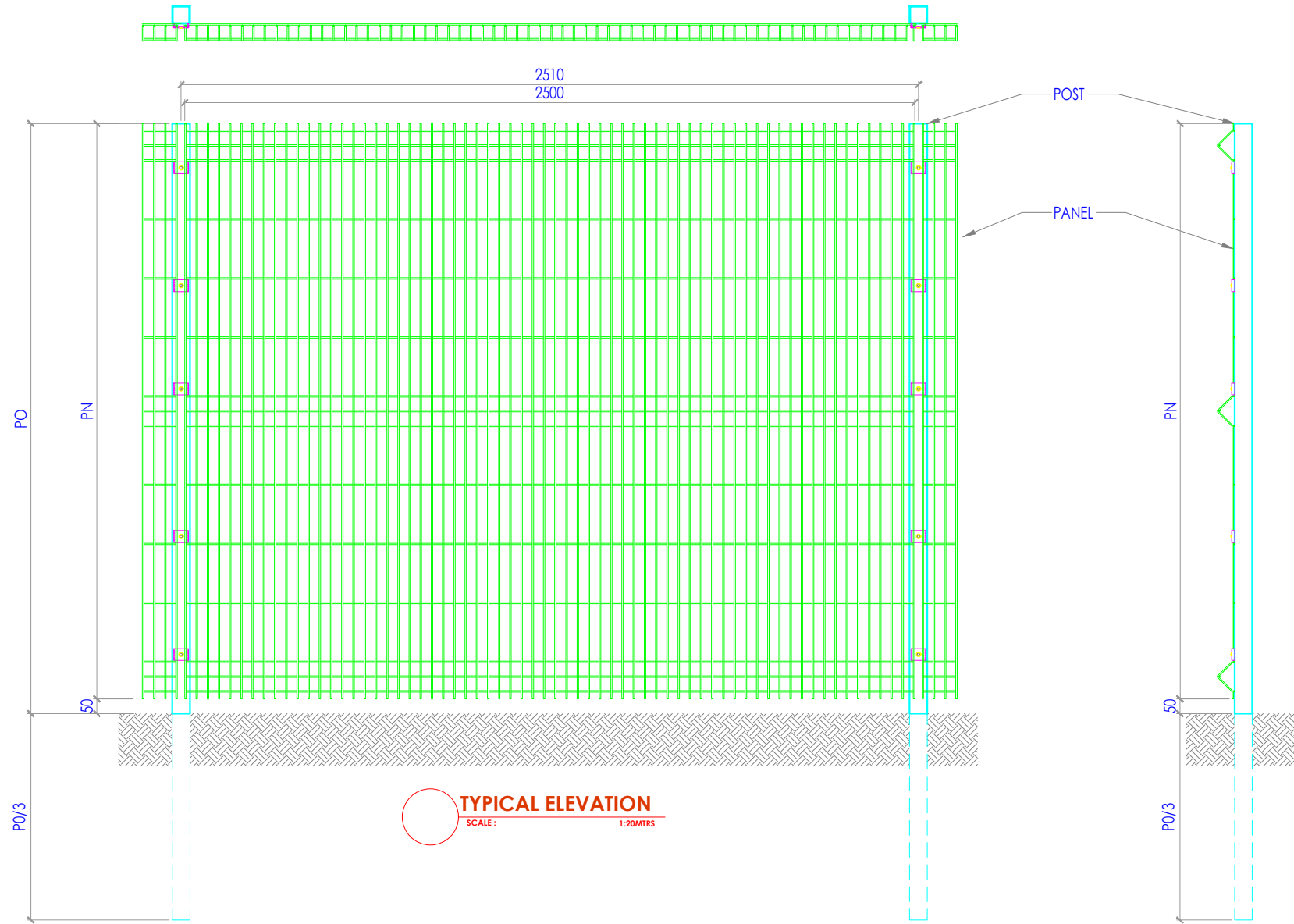

TYPICAL ELEVATION
SCALE: 1:20MTRS

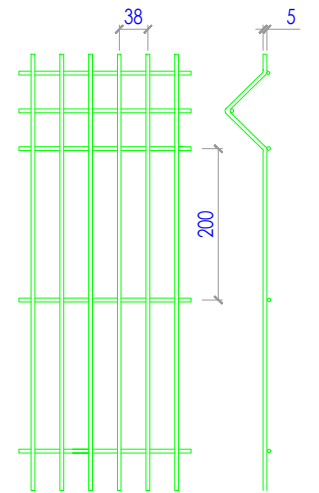

MESH DETAIL
SCALE: 1:10MTRS

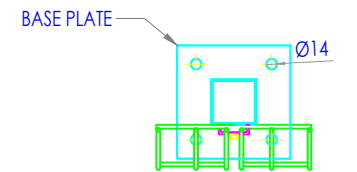
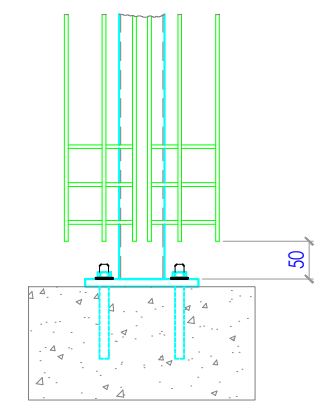

BASE PLATED
OPTIONAL

NOTE:

1. ALL DIMENSIONS ARE IN MILLIMETERS UNLESS OTHERWISE NOTED.

FINISH:

2. HOT DIP GALVANIZED TO BS EN ISO 1461
3. HOT DIP GALVANIZED AND POWDER COATED TO BS EN 13438
4. MARINE COAT FOR INSTALLATIONS WITHIN 500M OF SALT WATER OR AN ESTUARY

MATERIAL LIST:

ITEM CODE	POST HEIGHTS (PO)	PANEL HEIGHTS (PN)	POST SIZES	WIRE DIA	MESH OPENING	POST BASE PLATED	POST EMBEDDED IN GROUND	SUPPLIER:		CLIENT:		
H3D38100	1000 mm	1x950 mm	50x50x2 mm	5 mm	38x200 mm	√	√	<div><div><div>شركة</div><div>HITECH</div><div>الذخيرة العليا للصناعة</div></div><div><div>STEEL INDUSTRIES CO.</div><div>EXIT 13 AL KHARJ ROAD 2ND INDUSTRIAL AREA RIYADH PO BOX 325752 RIYADH 11371 TEL. NO.: 011 208 007 FAX NO.: 011 291 4419</div></div></div>		HITECH 3D38		
H3D38150	1500 mm	1x1450 mm	50x50x2 mm	5 mm	38x200 mm	√	√					
H3D382000	2000 mm	1x1950 mm	60x60x2 mm	5 mm	38x200 mm	√	√					
H3D382400	2450 mm	1x950 mm 1x1450 mm	60x60x2 mm	5 mm	38x200 mm	√	√					
H3D382900	2950 mm	2x1450 mm	60x60x2 mm	5 mm	38x200 mm	√	√	DESIGNED BY: MJJ	DRAWING TITLE: GENERIC HIWELD 3D38		PAPER SIZE: A3	SHEET NO. 01
H3D383900	3950 mm	2x1950 mm	50x100x2 mm	5 mm	38x200 mm	√	√	DRAWN BY: RAMEEZ				
								CHECKED BY: ADT	DRAWING NO.: HIWELD -3D38 - 000		REV. NO. A	SCALE: AS SHOWN
H3D385850	5900mm	3x1950 mm	50x100x2 mm	5 mm	38x200 mm	√	√	APPROVED BY: MJJ				DATE: 26-04-2022